

# Nouveau tracé 2/2

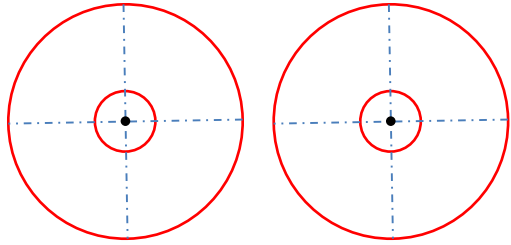

4 x Roues - Epaisseur 8 mm

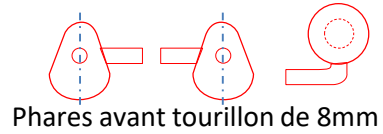
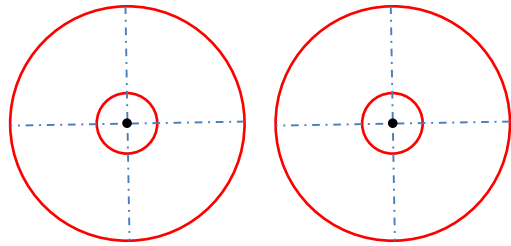

Phares avant tourillon de 8mm



Volant ép. 2mm  
Axe de 3mm

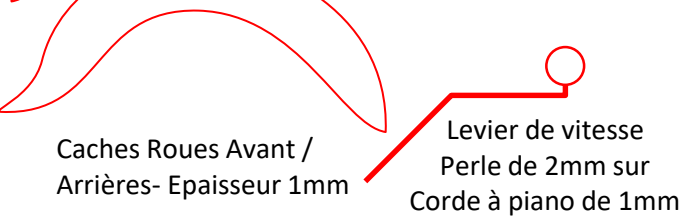

Caches Roues Avant /  
Arrières- Epaisseur 1mm

Levier de vitesse  
Perle de 2mm sur  
Corde à piano de 1mm

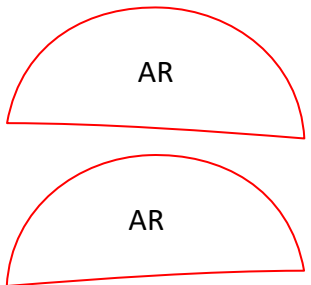

AR

AR

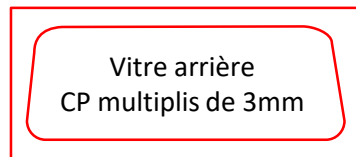

Vitre arrière  
CP multiplis de 3mm

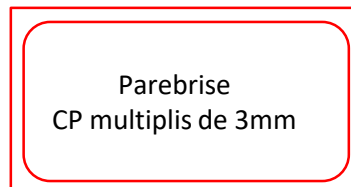

Parebrise  
CP multiplis de 3mm

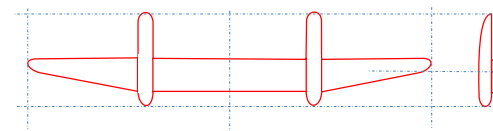

Pare choc avant  
Epaisseur 1 mm

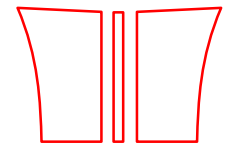

Calandre avant  
Epaisseur 1 mm

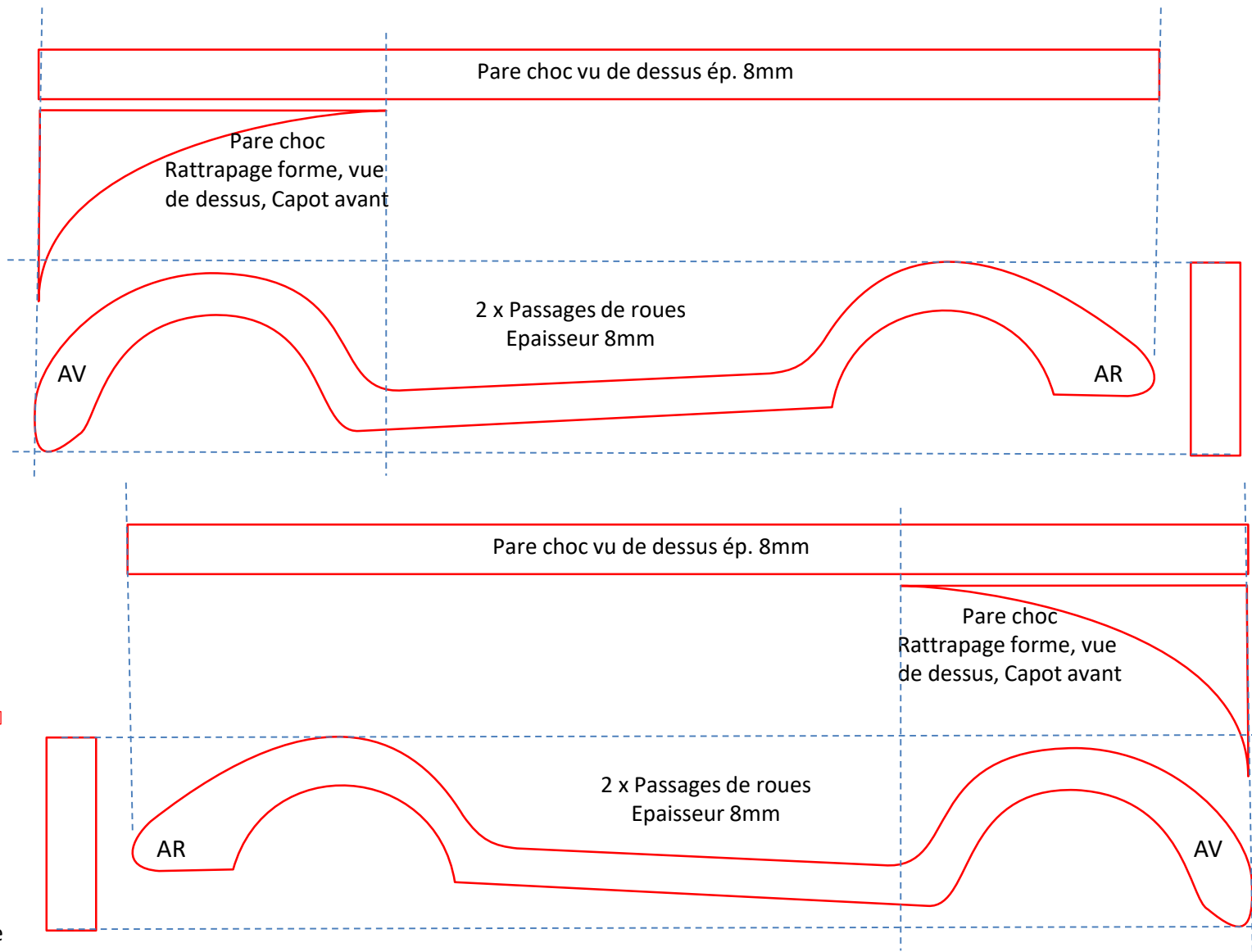

Pare choc vu de dessus ép. 8mm

Pare choc  
Rattrapage forme, vue  
de dessus, Capot avant

2 x Passages de roues  
Epaisseur 8mm

AV

AR

Pare choc vu de dessus ép. 8mm

Pare choc  
Rattrapage forme, vue  
de dessus, Capot avant

2 x Passages de roues  
Epaisseur 8mm

AR

AV